

Original MINI Accessories.

Installation Instructions.



Illuminated Door Sill Strips Retrofit

MINI ONE (R50)

MINI COOPER (R50)

MINI Convertible (R52)

MINI COOPER S (R53)

Retrofit kit No.	51 47 0 302 686	Retrofit kit Illuminated door sill strip
	51 47 0 302 683	Retrofit kit Illuminated door sill strip
	51 47 0 404 911	Retrofit kit Illuminated door sill strip
	51 47 0 416 145	Retrofit kit Illuminated door sill strip
	51 47 0 417 011	Illuminated door sill strip "Union Jack"
	51 47 0 417 015	Illuminated door sill strip "Union Jack"
	51 47 0 417 112	Illuminated door sill strips, personalised
	51 47 0 417 118	Illuminated door sill strips, personalised
	51 47 0 417 688	Retrofit kit Illuminated door sill strip
	51 47 0 417 692	Retrofit kit Illuminated door sill strip
	51 47 0 417 695	Retrofit kit Illuminated door sill strip

Installation time

The installation time is approx. 2.5 hours, but may vary depending on the condition of the car and the equipment in it.

Important information

These installation instructions are primarily designed for use within the BMW dealership organisation and by authorised BMW service companies.

In any event, the target group for these installation instructions is specialist personnel trained on BMW cars with the appropriate specialist knowledge.

All work must be completed using the latest BMW repair manuals, circuit diagrams, servicing manuals and work instructions, in a rational order, using the prescribed tools (special tools) and observing current health and safety regulations.

To avoid unnecessary extra work and/or costs, if any installation or function problem occurs, after a brief troubleshooting session (approx. 0.5 hours), please contact the following:

- 1. Either your national subsidiary or your regional office, or**
- 2. The Support team via the Aftersales Assistance Portal (ASAP), using the optional technical parts support application.**

Specify the chassis number and the part number of the installed retrofit kit and give a precise description of the problem.

Do not archive the hard copy of these installation instructions since daily updates are made by ASAP!

See ASAP for details of the pictograms.

Pictograms:



Denotes instructions that draw your attention to special features.

◀ Denotes the end of the instruction or other text.

Subject to technical modifications.

Installation information

All pictures show LHD cars; proceed accordingly on RHD cars.

All the figures show the right-hand side of the card. Proceed in exactly the same way on the left-hand side.

Ensure that the cables/lines are not kinked or damaged as you install them in the car. Costs incurred as a result of this will not be reimbursed by BMW AG.

Additional cables/lines that you install must be secured with cable ties.

If the specified PIN chambers are occupied, bridges, double crimps or twin-lead terminals must be used.

Deburr holes and treat them with anti-corrosive coatings as set out in MINI directives to protect them from corrosion.

Special tools required

None

Contents

Section	Page
1. Parts overview	4
2. Preparatory work	5
3. Adapter cable A connection diagram	6
4. Installation and cabling diagram	7
5. To install the illuminated door sill strip	8
6. Concluding work	10
7. Circuit diagram	11

1. Parts overview

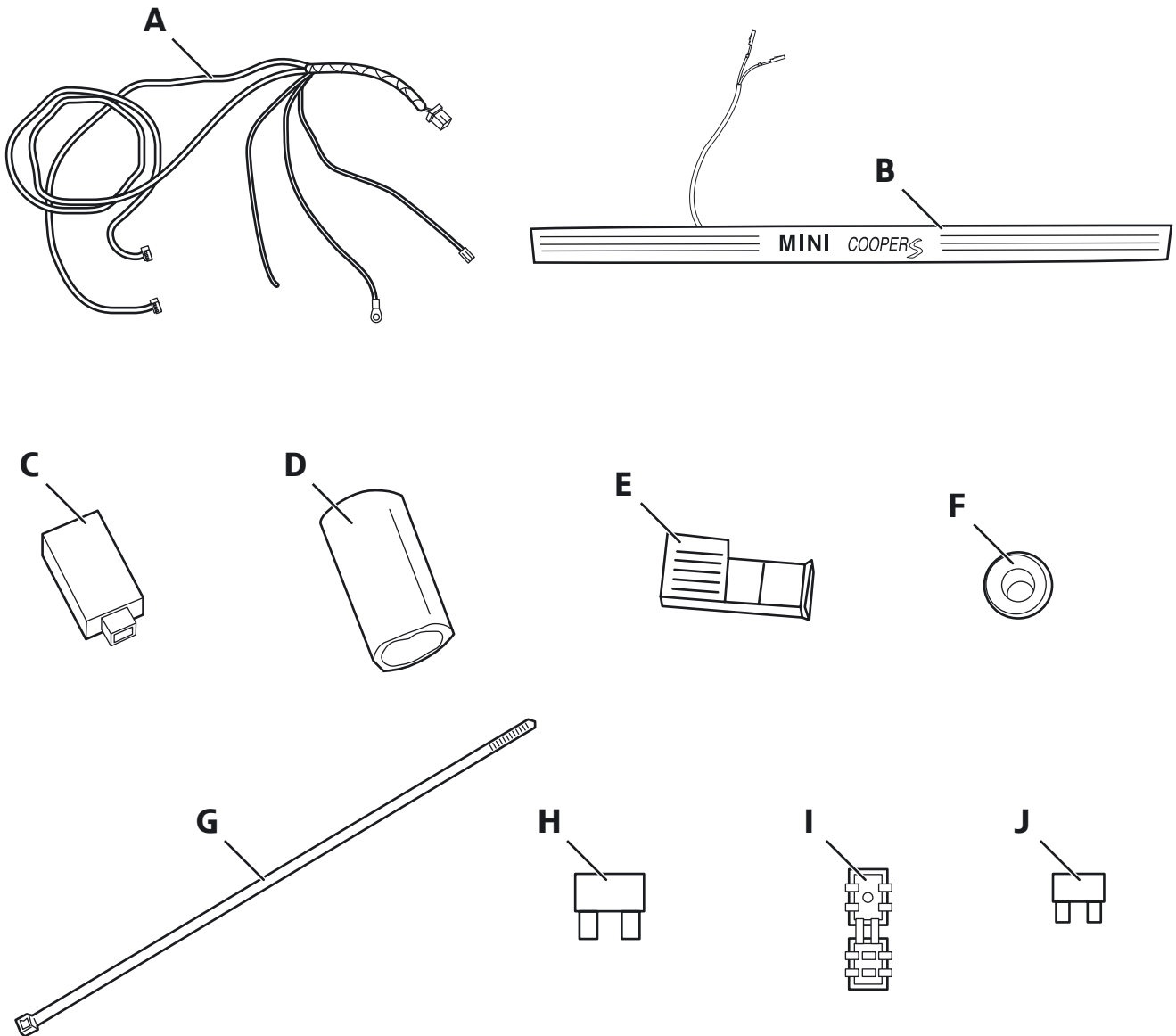

R50 1463 Z

Legend

- A** Adapter cable
- B** Illuminated door sill strip (2x)
- C** Inverter
- D** Protective cover
- E** Plug casing (2x)
- F** Rubber grommet (4x)
- G** Cable tie (10x)
- H** Blade terminal fuse, 5 A
- I** Insulation-piercing connector (2x)
- J** Mini Blade terminal fuse, 5 A (not required)

2. Preparatory work

	TIS No.
Read the error memory	---
Disconnect battery	12 00 ...
The following components must be removed first of all	
Door sill strips on both sides (no longer required)	---
Door sill covers strips, right and left	51 47 000
Release fuse holder	61 13 ...

3. Adapter cable A connection diagram

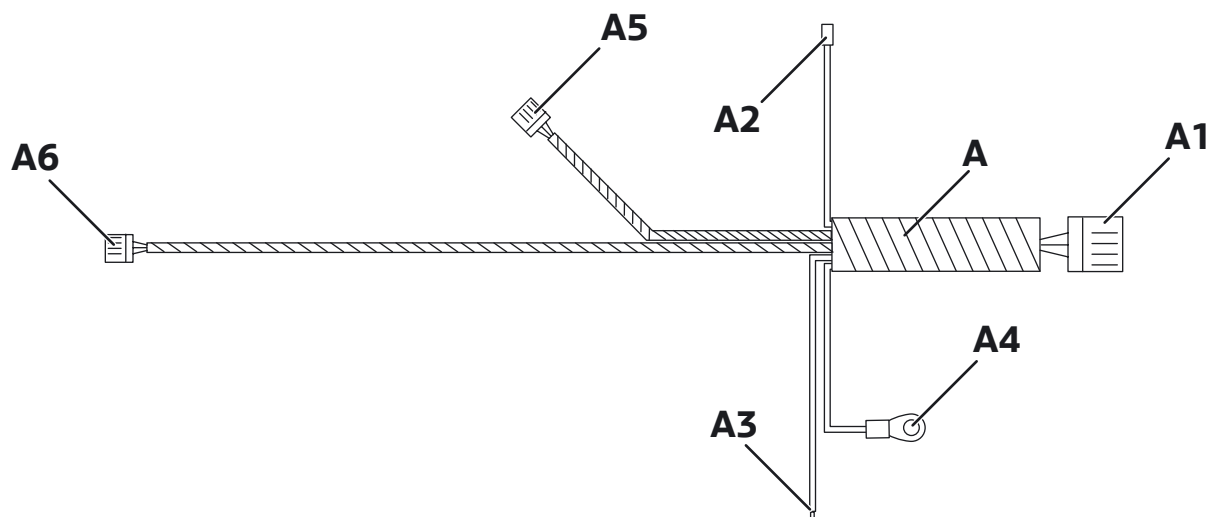

050 0329 B

Item	Designation	Signals	Cable colors	Connection location in the car	Abbreviation/Slot
A	Adapter cable	---	---	---	---
A1	8-pin SW socket casing	---	---	Inverter C	---
A2	Socket contact	Terminal 30	0.5 mm ² RT	To fuse strip on the left	X10200 PIN 4
A3	Open cable end or socket contact	IB	0.5 mm ² RT/SW	To base module	X253 PIN 7
A4	Cable lug, 6 mm in diameter	Terminal 31	0.5 mm ² BR	To earth post connection on A pillar right	X151
A5	3-pin socket casing	---	---	To right-hand door sill strip B	---
A6	3-pin socket casing	---	---	To left-hand door sill strip B	---

4. Installation and cabling diagram

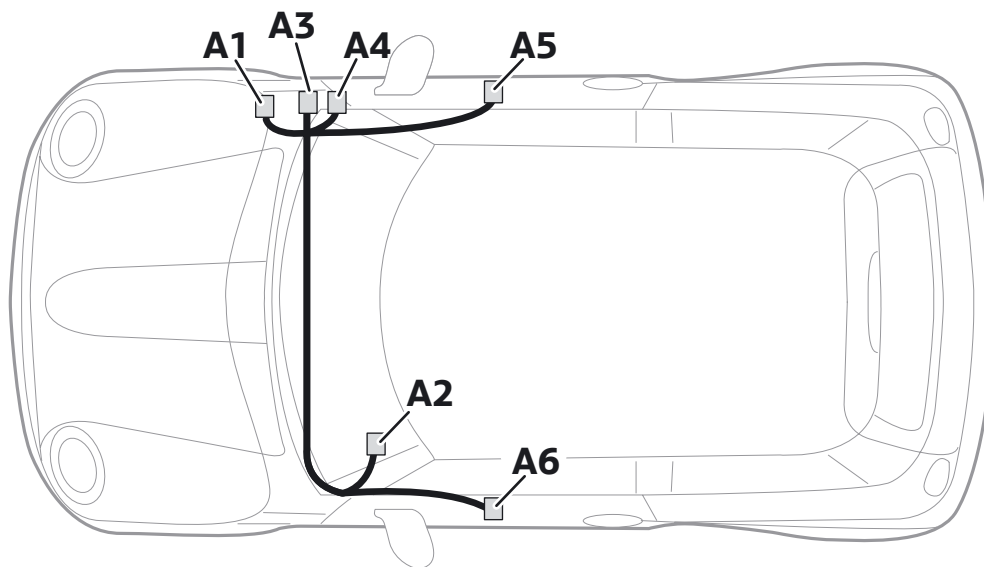

050 0328 B

Legend

- A1** To inverter **C**
- A2** To X10200, PIN 4
- A3** To X253, PIN 7
- A4** To X151
- A5/A6** To door sill strips **B**

Tie back any excess lengths.

5. To install the illuminated door sill strip

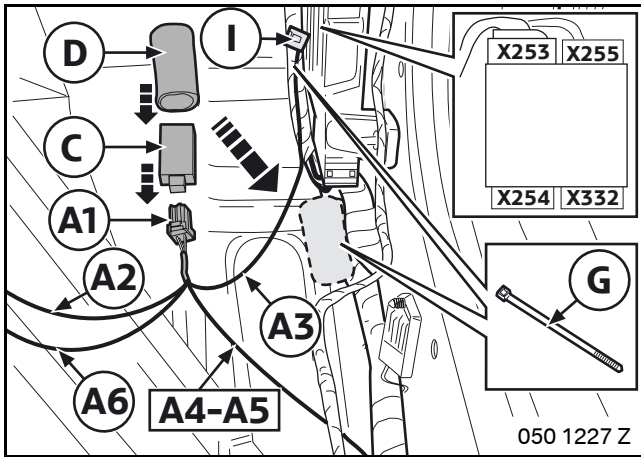

▶ Figure A shows the front right A pillar. ◀

Push the protective cover **D** over the inverter **C**. Connect branch **A1** on the wiring harness **A** to the inverter **G**.

Position the inverter **C** with the protective sheath **D** behind the carpet between the base module and earth post.

Then secure the inverter **C** with a cable tie **G** to the side of the top section of the main wiring harness.

▶ If there is a socket contact on branch **A3**, disconnect it. ◀

Connect branch **A3** to the base module (A pillar at the front right) **X253** (54-pin SW), **PIN 7** (BR/GE cable) using an insulation-piercing connector **I**.

▶ Figure A shows the front right A pillar. ◀

Connect branch **A4** on the adapter wiring harness **A** to earth post **X151** at the front right.

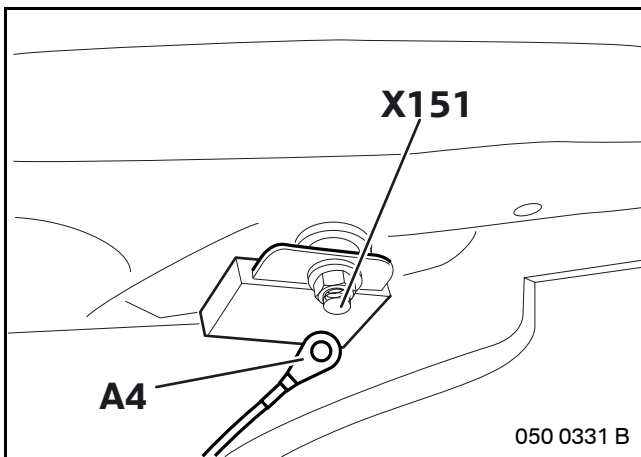

▶ Figure A shows the front left A pillar. ◀

Connect branch **A2** to **X10200** (12-pin SW), **PIN 4** (1).

If **PIN 4** is occupied, cut the plug off branch **A2** and connect it to **X10200**, **PIN 4** (RT/GN cable) using an insulation-piercing connector **I**.

▶ If there is not a fuse in slot 3, insert a fuse **H**. ◀

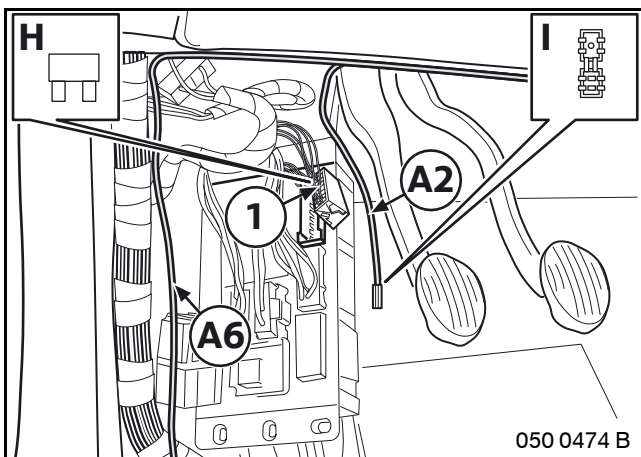

5. To install the illuminated door sill strip

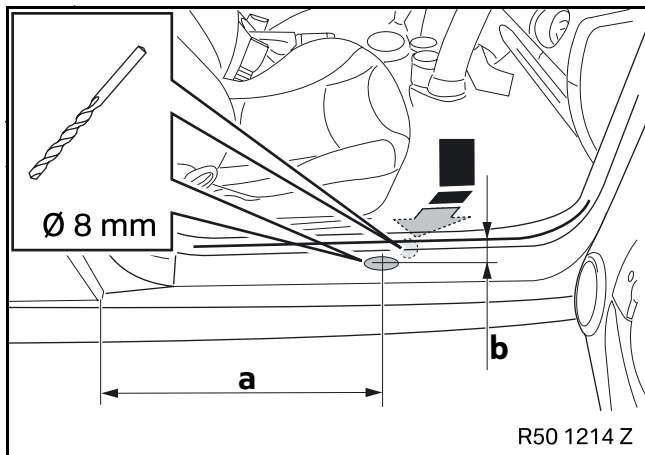

▶ The figure shows the door sill at the front right. ◀

Drill a 8 mm hole at the point shown on the side skirt fold at the front and drill a hole in the interior in the same place.

a = 750 mm

b = 45 mm

▶ Only expand drill the plastic skirt with a 12 mm hole. ◀

Deburr holes and treat them with anti-corrosive coatings as set out in MINI directives to protect them from corrosion.

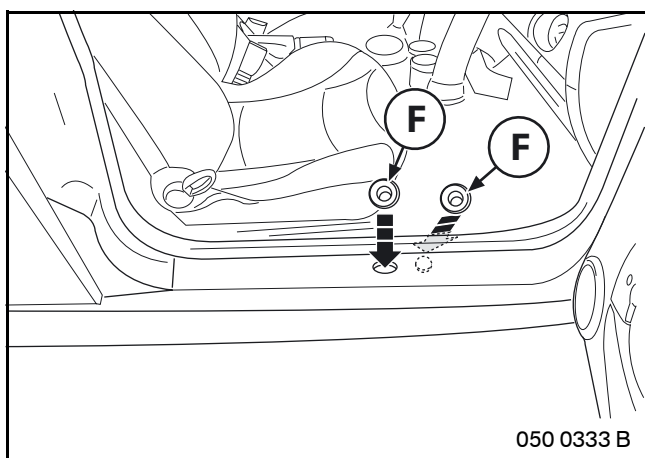

▶ The figure shows the door sill at the front right. ◀

Insert rubber grommets F into the holes.

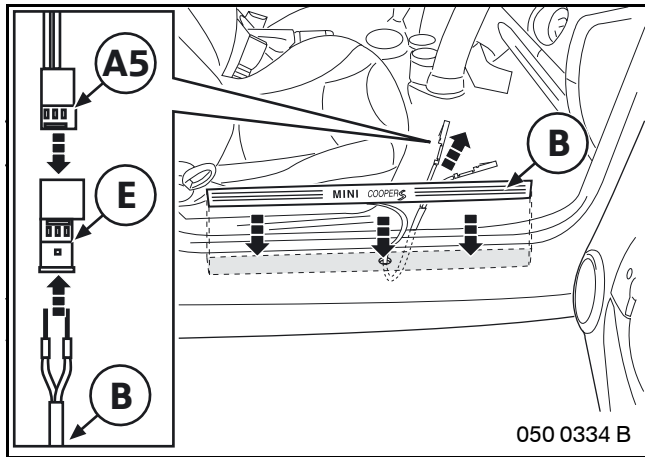

▶ The figure shows the door sill, front right.
On cars with the aerodynamics package ensure that the door sill strip **B** is positioned in the center.

Check part numbers of the door sill strips **B**.

Left side:

51 47 0 302 684
51 47 0 302 687
51 47 0 404 912
51 47 0 416 146
51 47 0 417 012
51 47 0 417 016
51 47 0 417 113
51 47 0 417 119
51 47 0 417 690
51 47 0 417 693
51 47 0 417 696

Right side:

51 47 0 302 685
51 47 0 302 688
51 47 0 404 913
51 47 0 416 147
51 47 0 417 013
51 47 0 417 017
51 47 0 417 117
51 47 0 417 120
51 47 0 417 691
51 47 0 417 694
51 47 0 417 697 ◀

Route the 2-pin cable from the door sill strip **B** through the rubber grommets into the interior.

Connect the plug contacts on door sill strip **B** into plug casing **E**, chambers 1 and 2 and connect this to branch **A5** on the adapter wiring harness.

Remove the backing foil from the adhesive strips on the reverse of the illuminated door sill strip **B** and affix the door sill strip **B**.

6. Concluding work

This retrofit system does not require coding.

- Connect the battery
- Conduct a function test
- Conduct a brief test
- Re-assemble the car

7. Circuit diagram

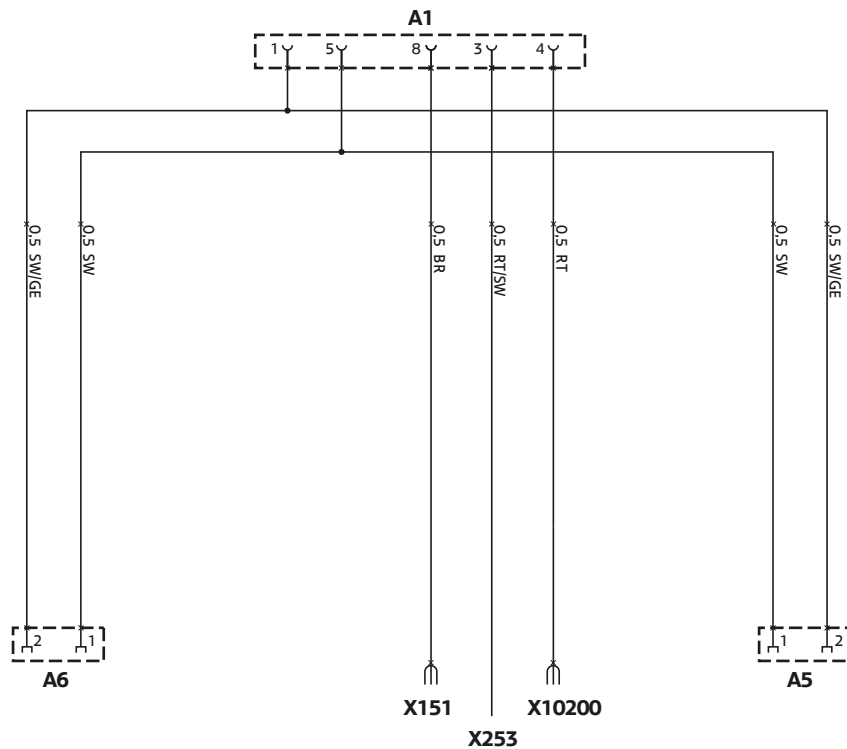

R50 1464 Z

Legend

- A1* 8-pin socket casing, to inverter
- X10200 Socket contact, in fuse strip on the left, PIN 4
- X253 Open cable end, signal IB, in base module, PIN 7
- X151 Cable lug, 6 mm in diameter, to earth post connection on A pillar right
- A5* 3-pin socket casing, to right-hand door sill strip
- A6* 3-pin socket casing, to left-hand door sill strip

The components marked with an asterisk (*) are only valid for this circuit diagram.
All the other components and X designations correspond to BMW after-sales circuit diagrams

Cable colors

- BL Blue
- BR Brown
- GE Yellow
- GN Green
- GR Grey
- OR Orange
- RT Red
- SW Black
- VI Violet
- WS White